

SITE LOCATION MAP

Project #: 11112
 For: Pennington Chen Interests, LLC
 Location: SE of Red Bluff and Genoa Red Bluff Rd
 Harris County, Texas

REVISIONS

BERG•OLIVER ASSOCIATES, INC.
 ENVIRONMENTAL SCIENCE & LAND USE CONSULTANTS
 14701 ST. MARY'S LANE, SUITE 400
 HOUSTON, TEXAS 77079 PHONE (281)589-0898 <http://www.bergoliver.com>





2009 NAIP INFRARED AERIAL

Project #: 11112N-WD
 For: Baywood Newco, L.P.
 Location: SE of Red Bluff and Genoa Red Bluff Rd - Baywood
 Harris County, Texas

REVISIONS

BERG ♦ OLIVER ASSOCIATES, INC.
 ENVIRONMENTAL SCIENCE & LAND USE CONSULTANTS
 14701 ST. MARY'S LANE, SUITE 400
 HOUSTON, TEXAS 77079 PHONE (281)589-0898 <http://www.bergoliver.com>





1995 TXDOQQ INFRARED AERIAL

Project #: 11112N-WD
 For: Baywood Newco, L.P.
 Location: SE of Red Bluff and Genoa Red Bluff Rd - Baywood
 Harris County, Texas

REVISIONS

BERG ♦ OLIVER ASSOCIATES, INC.
 ENVIRONMENTAL SCIENCE & LAND USE CONSULTANTS
 14701 ST. MARY'S LANE, SUITE 400
 HOUSTON, TEXAS 77079 PHONE (281)589-0898 <http://www.bergoliver.com>



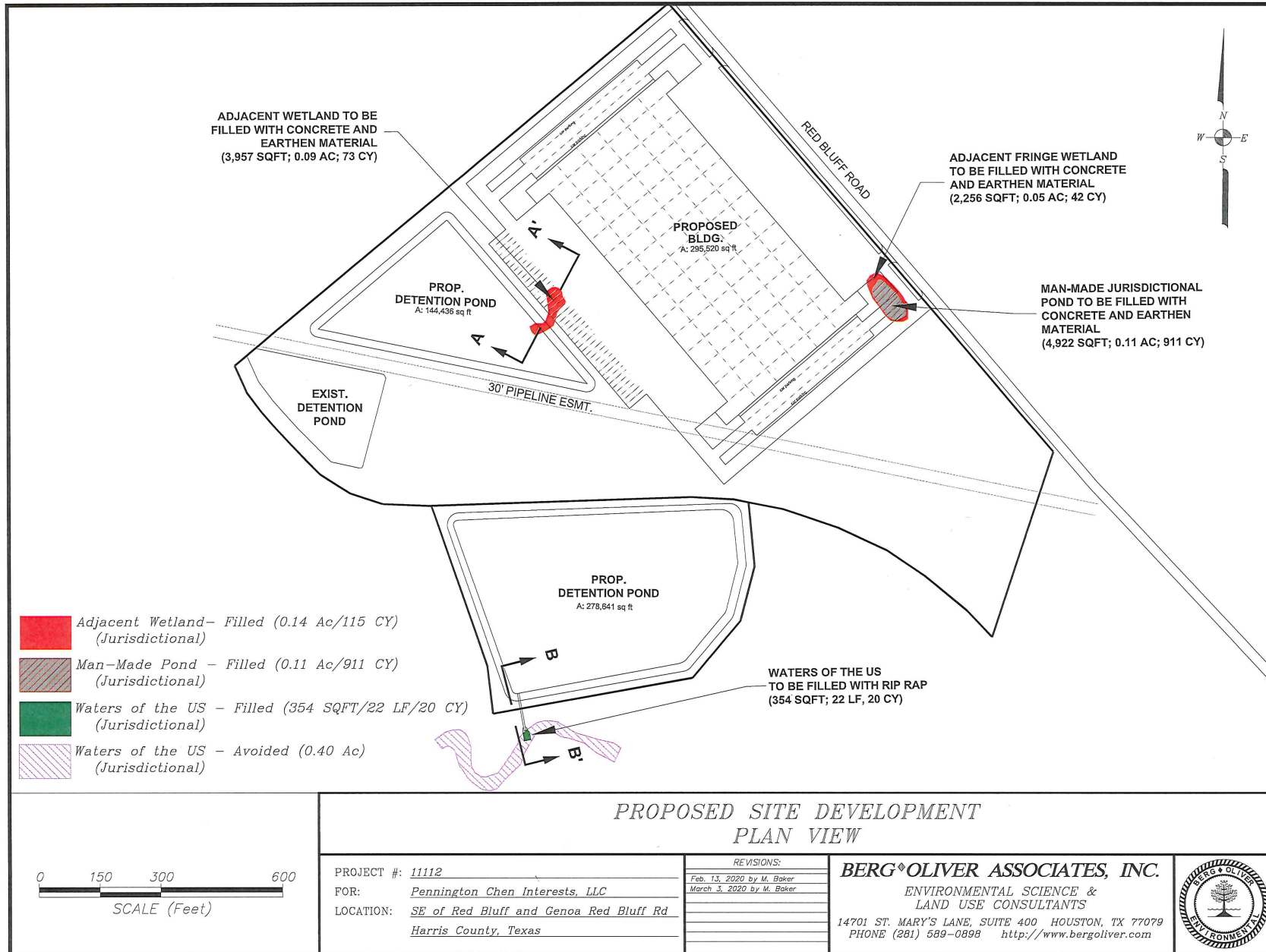

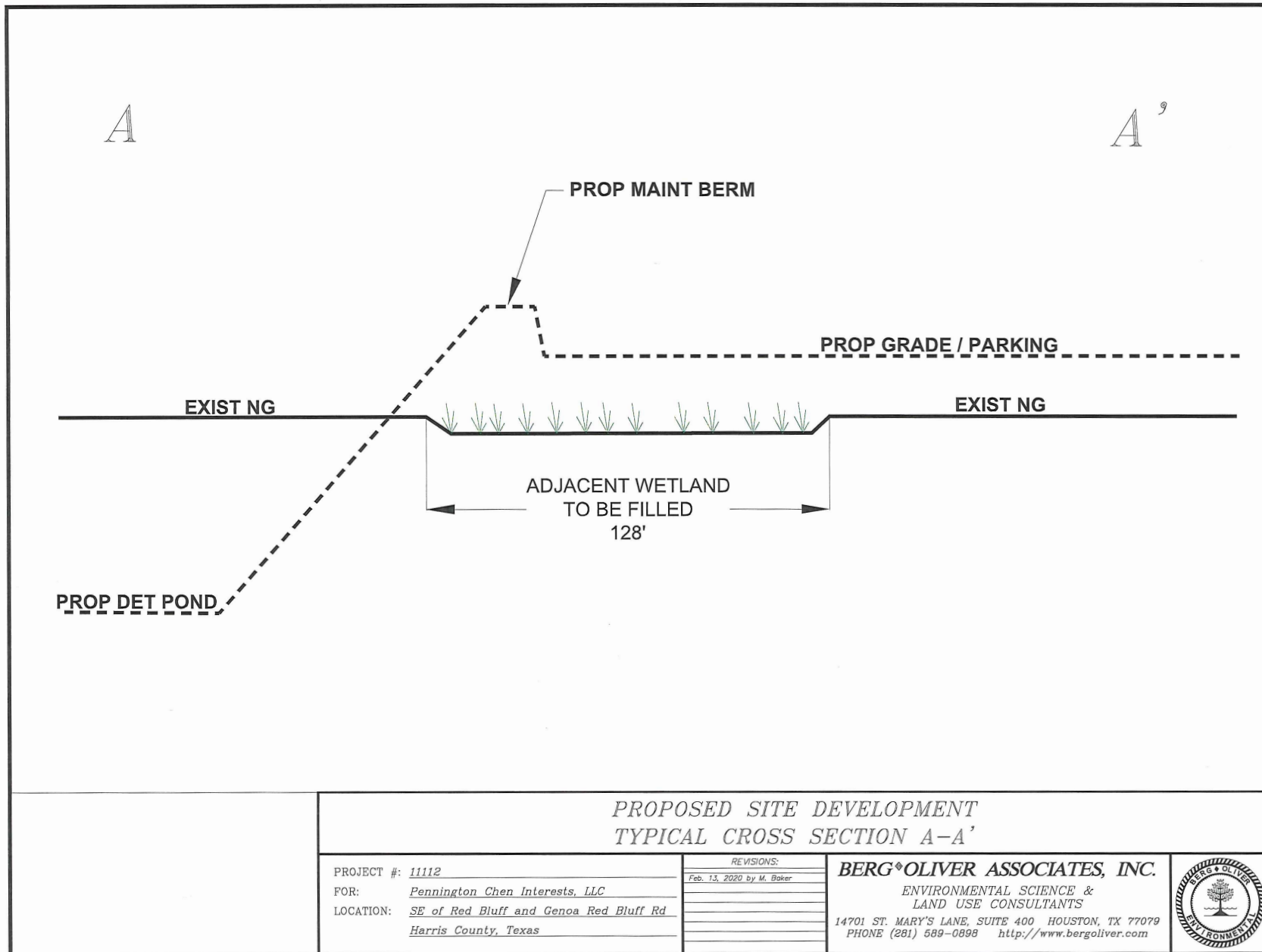

PROPOSED SITE DEVELOPMENT
TYPICAL CROSS SECTION A-A'

PROJECT #: 11112
 FOR: Pennington Chen Interests, LLC
 LOCATION: SE of Red Bluff and Genoa Red Bluff Rd
 Harris County, Texas

REVISIONS:
Feb. 13, 2020 by M. Baker

BERG • OLIVER ASSOCIATES, INC.
 ENVIRONMENTAL SCIENCE &
 LAND USE CONSULTANTS
 14701 ST. MARY'S LANE, SUITE 400 HOUSTON, TX 77079
 PHONE (281) 589-0898 <http://www.bergoliver.com>



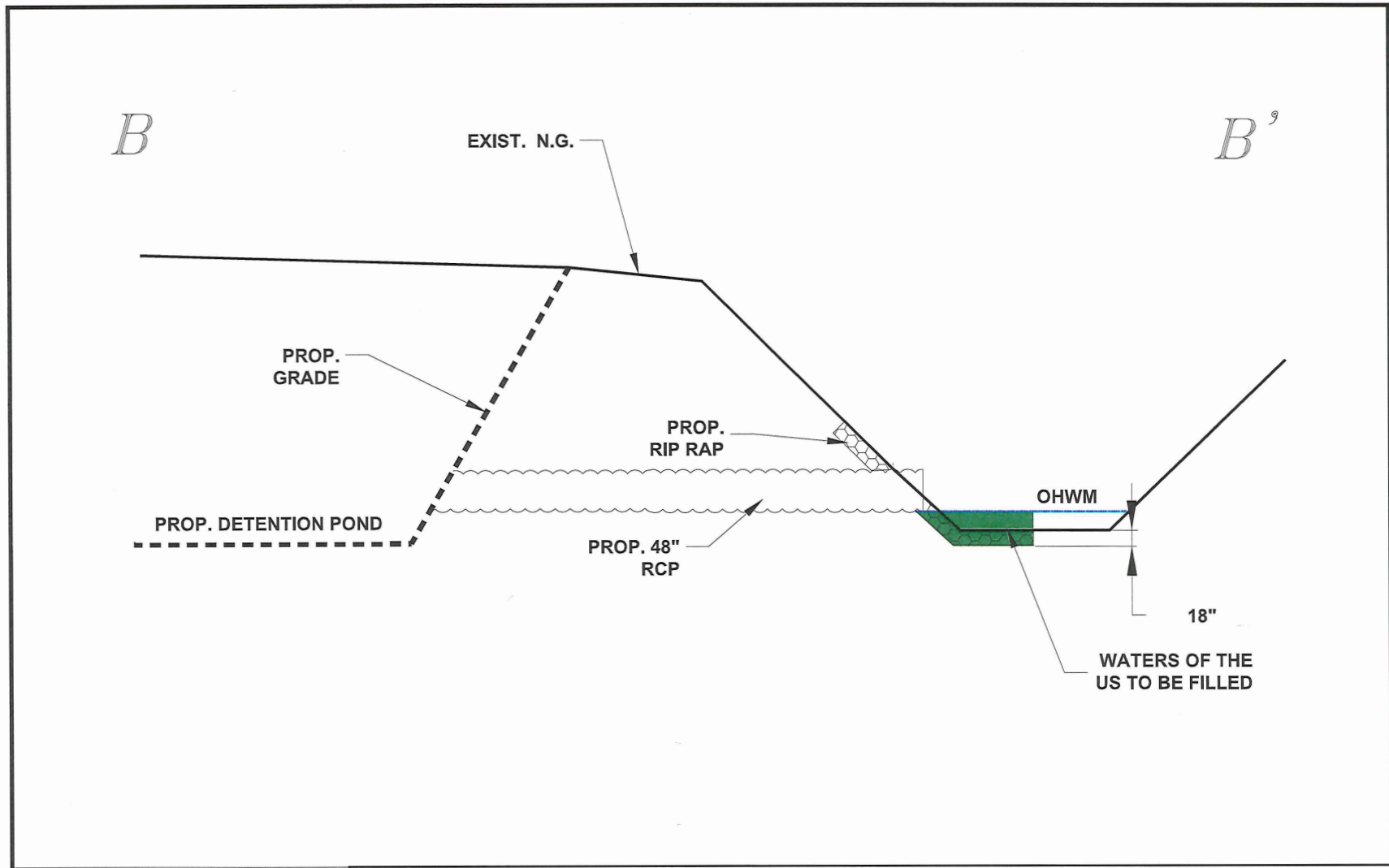

PROPOSED SITE DEVELOPMENT
TYPICAL CROSS SECTION B-B'

PROJECT #: 11112
 FOR: Pennington Chen Interests, LLC
 LOCATION: SE of Red Bluff and Genoa Red Bluff Rd
 Harris County, Texas

REVISIONS:
Feb. 13, 2020 by M. Baker

BERG & OLIVER ASSOCIATES, INC.
 ENVIRONMENTAL SCIENCE &
 LAND USE CONSULTANTS
 14701 ST. MARY'S LANE, SUITE 400 HOUSTON, TX 77079
 PHONE (281) 589-0898 <http://www.bergoliver.com>

